

Appendix 1: Main SRFI Site Parameters Plans



- LEGEND
- ORDNANCE SURVEY (c) CROWN COPYRIGHT 2017. ALL RIGHTS RESERVED. LICENCE NUMBER 100022432. COPYRIGHT RESERVED

BASED ON MK SURVEYS', TOPOGRAPHICAL SURVEY DRAWING. REF: 2223. DATED JULY 2016. AND ORDNANCE SURVEY INFORMATION.
- ORDER LIMITS

PROPOSED PUBLIC RIGHT OF WAY

PROPOSED LANDSCAPED OPEN SPACE (INCLUDING SCREENING AND BUNDING)

FARMLAND TO BE RETAINED

FLOOD ATTENUATION

DEVELOPMENT PLATEAU

INTERMODAL AREA

POTENTIAL VEHICULAR ACCESS

MILTON MALSOR BROOK

MILTON MALSOR BROOK DIVERTED

NEW ROAD INFRASTRUCTURE

NEW ROAD INFRASTRUCTURE AND IMPROVEMENTS TO EXISTING INFRASTRUCTURE INCLUDING LANDSCAPING

AREA FOR BUS INTERCHANGE

BUILDINGS TO BE DEMOLISHED

BARN TO BE RETAINED/RESTORED FOR BATS/BARN OWLS

EXISTING CATENARY STRUCTURES

PROPOSED CATENARY STRUCTURES

RAIL TRACKS

POTENTIAL RAIL TRACKS

C	07-03-18	LEGEND UPDATED	PF	MS
B	28-02-18	TITLE UPDATED	PF	MS
A	12-02-18	LANDSCAPED OPEN SPACE UPDATED	PF	MS
D	06-02-18	FIRST ISSUE	PF	MS
REV	DATE	DETAILS OF ISSUE/REVISION	DRW	REV



THE RAIL CENTRAL RAIL
FREIGHT INTERCHANGE AND
HIGHWAY ORDER 201[x]

DRAWING TITLE
PARAMETERS PLAN
SHEET 1 OF 2

SCALE	1:2,500	DRAWN	PF
PAGE SIZE	A0	REVIEWED	MS
REGULATION	5(2)	DOCUMENT	
DRAWING STATUS	PLANNING		
DRAWING No	MSA-30708-PL-DCO-114	REVISION	C

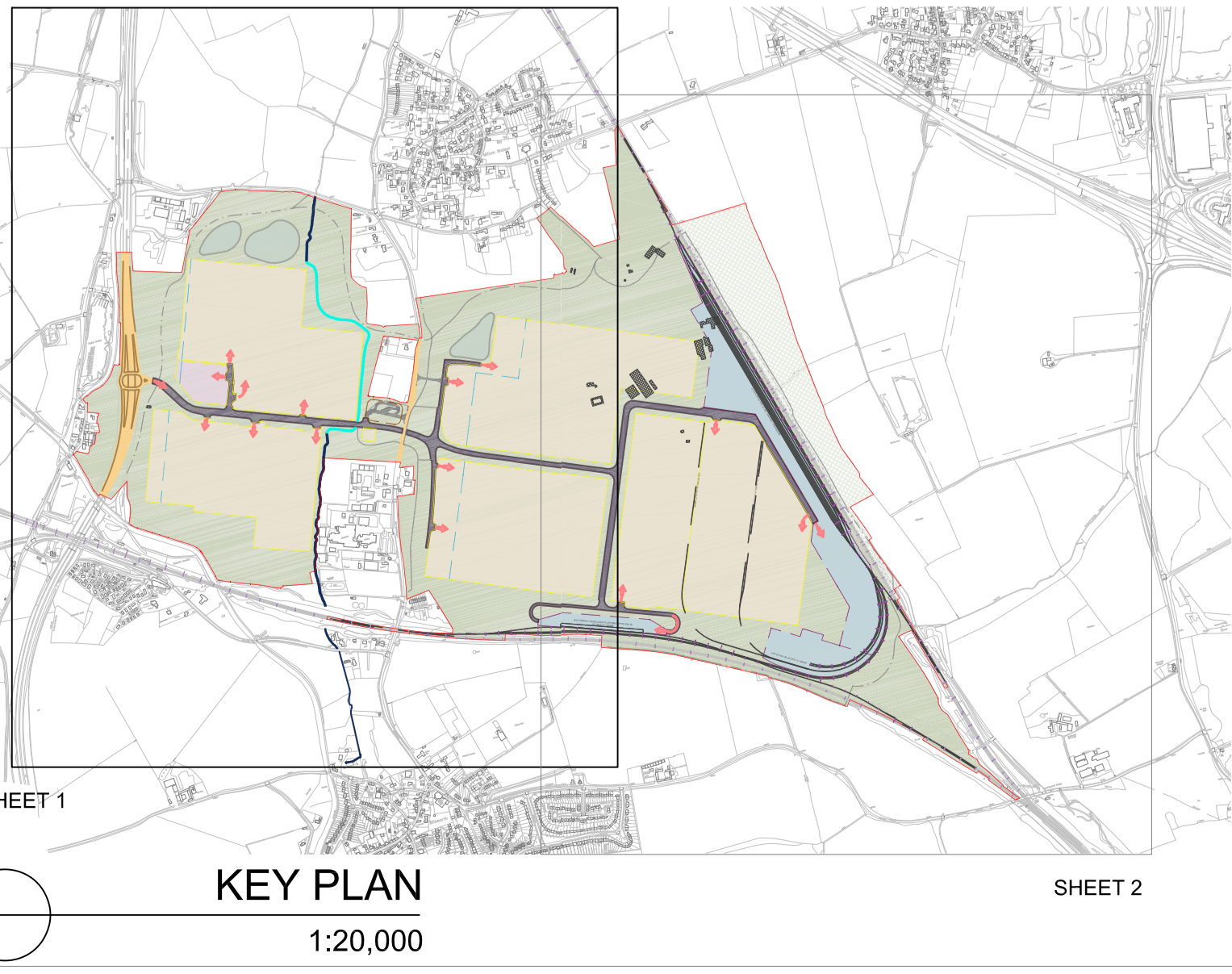

KEY PLAN
1:20,000

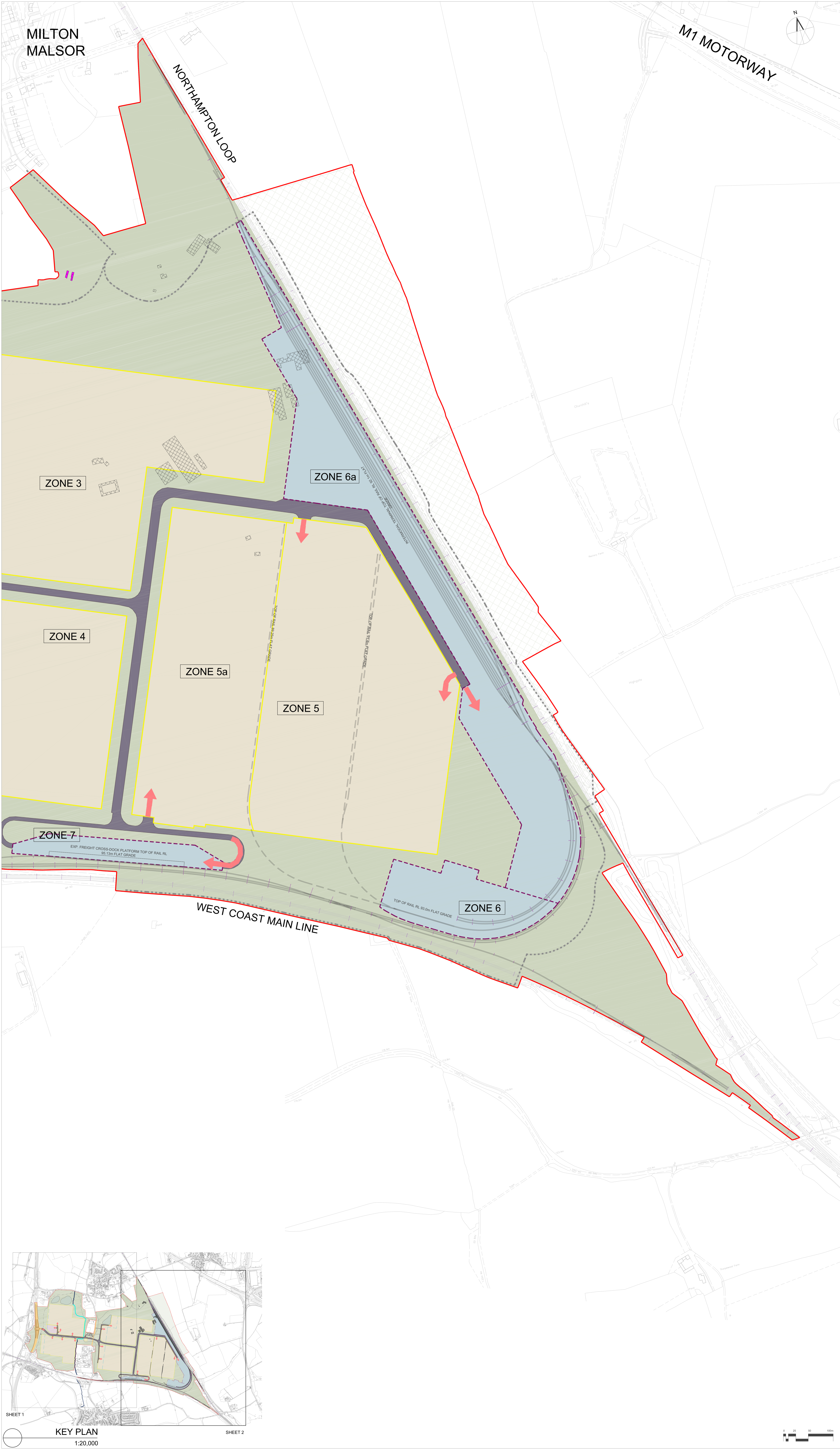

- LEGEND
- ORDNANCE SURVEY (c) CROWN COPYRIGHT 2017. ALL RIGHTS RESERVED. LICENCE NUMBER 100022432.
COPYRIGHT RESERVED
- BASED ON MK SURVEYS, TOPOGRAPHICAL SURVEY DRAWING.
REF: 2223. DATED JULY 2016. AND ORDNANCE SURVEY INFORMATION.
- ORDER LIMITS
 - PROPOSED PUBLIC RIGHT OF WAY
 - PROPOSED LANDSCAPED OPEN SPACE (INCLUDING SCREENING AND BUNDING)
 - FARMLAND TO BE RETAINED
 - FLOOD ATTENUATION
 - DEVELOPMENT PLATEAU
 - INTERMODAL AREA
 - POTENTIAL VEHICULAR ACCESS
 - MILTON MALSOR BROOK
 - MILTON MALSOR BROOK DIVERTED
 - NEW ROAD INFRASTRUCTURE
 - NEW ROAD INFRASTRUCTURE AND IMPROVEMENTS TO EXISTING INFRASTRUCTURE INCLUDING LANDSCAPING
 - AREA FOR BUS INTERCHANGE
 - BUILDINGS TO BE DEMOLISHED
 - BARN TO BE RETAINED/RESTORED FOR BATS/BARN OWLS
 - EXISTING CATENARY STRUCTURES
 - PROPOSED CATENARY STRUCTURES
 - RAIL TRACKS
 - POTENTIAL RAIL TRACKS

C	07-03-18	LEGEND UPDATED	PF	MS
B	28-02-18	TITLE UPDATED	PF	MS
A	12-02-18	LANDSCAPED OPEN SPACE UPDATED	PF	MS
D	06-02-18	FIRST ISSUE	PF	MS
REV	DATE	DETAILS OF ISSUE/REVISION	DRW	REV



THE RAIL CENTRAL RAIL
FREIGHT INTERCHANGE AND
HIGHWAY ORDER 2011[x]

DRAWING TITLE
PARAMETERS PLAN
SHEET 2 OF 2

SCALE	1:2,500	DRAWN	PF
PAGE SIZE	A0	REVIEWED	MS

REGULATION	DOCUMENT
5(2)	.

DRAWING STATUS
PLANNING

DRAWING No	REVISION
MSA-30708-PL-DCO-114	C

Appendix 2: Main SRFI Site Green Infrastructure Plans



LEGEND

- Existing Retained Vegetation
- Primary Green Infrastructure (Including woodland and hedgerow planting)
- Retained Farmland (within red line)
- Proposed Screening Mound (Including woodland and hedgerow planting)
- Proposed Attenuation Feature (Capacity and design as required by the Environmental Statement)
- Proposed Milton Brook Diversion
- Existing Milton Brook Profile Retained
- Proposed Combined Cycleway / Public Footpath
- Proposed Public Footpath
- Development Plateau
- Intermodal Area
- New Road Infrastructure and Improvements to Existing Road Infrastructure
- Line of Underground Oil Pipeline and 10m Easement Zone
- Minimum Bund Height (AOD)
- Building Line Limit
- Site Boundary

A	05/03/18	Client name amended	CS
REV	DATE	DETAILS OF ISSUE/REVISION	DRW REV

ASHFIELD LAND
MANAGEMENT LIMITED AND
GAZELEY GLP
NORTHAMPTON S.A.R.L



THE RAIL CENTRAL RAIL
FREIGHT INTERCHANGE
AND HIGHWAY ORDER
201[X]

DRAWING TITLE
Parameter Plan -
Green Infrastructure Plan
Sheet 1 of 3 at 1:2500

SCALE	1:2500	DRAWN	CS
PAGE SIZE	A1	REVIEWED	BC
REGULATION	5 (2) (o)	DOCUMENT	Parameter Plan

DRAWING STATUS
Planning

DRAWING No	REVISION
1627-15-106	A



LEGEND

- Existing Retained Vegetation
- Primary Green Infrastructure (Including woodland and hedgerow planting)
- Retained Farmland (within red line)
- Proposed Screening Mound (Including woodland and hedgerow planting)
- Proposed Attenuation Feature (Capacity and design as required by the Environmental Statement)
- Proposed Milton Brook Diversion
- Existing Milton Brook Profile Retained
- Proposed Combined Cycleway / Public Footpath
- Proposed Public Footpath
- Development Plateau
- Intermodal Area
- New Road Infrastructure and Improvements to Existing Road Infrastructure
- Line of Underground Oil Pipeline and 10m Easement Zone
- Minimum Bund Height (AOD) +98m
- Building Line Limit
- Site Boundary

REV	DATE	DETAILS OF ISSUE/REVISION	DRW	REV
A	05/03/18	Client name amended	CS	

ASHFIELD LAND MANAGEMENT LIMITED AND GAZELEY GLP NORTHAMPTON S.A.R.L

Rail Central
Northamptonshire

THE RAIL CENTRAL RAIL FREIGHT INTERCHANGE AND HIGHWAY ORDER 201[X]

DRAWING TITLE
Parameter Plan - Green Infrastructure Plan
Sheet 2 of 3 at 1:2500

SCALE	1:2500	DRAWN	CS
PAGE SIZE	A1	REVIEWED	BC
REGULATION	5 (2) (o)	DOCUMENT	Parameter Plan
DRAWING STATUS	Planning		
DRAWING No	1627-15-107	REVISION	A

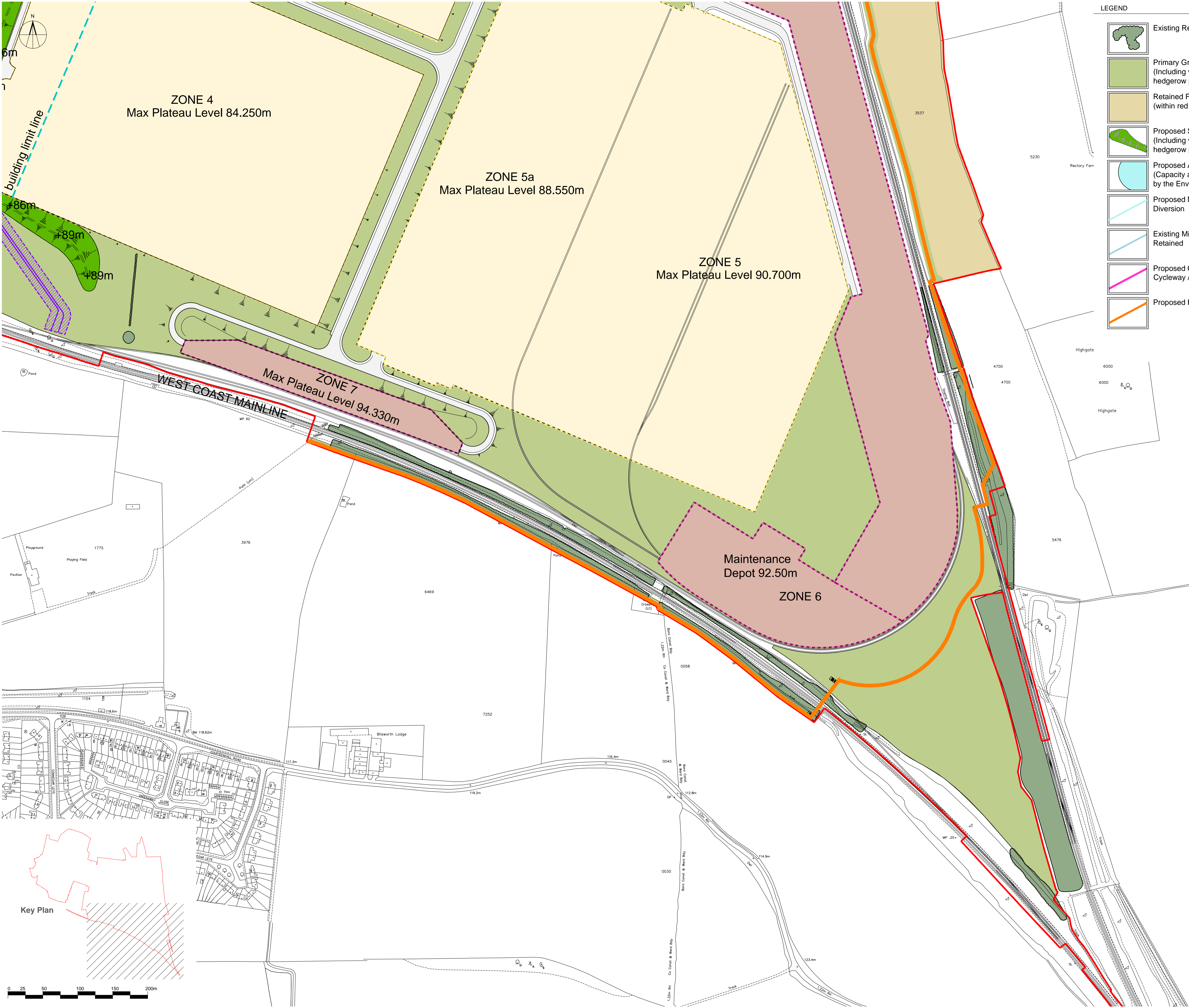

- LEGEND
- Existing Retained Vegetation

Primary Green Infrastructure
(Including woodland and hedgerow planting)

Retained Farmland
(within red line)

Proposed Screening Mound
(Including woodland and hedgerow planting)

Proposed Attenuation Feature
(Capacity and design as required by the Environmental Statement)

Proposed Milton Brook Diversion

Existing Milton Brook Profile Retained

Proposed Combined Cycleway / Public Footpath

Proposed Public Footpath
- Development Plateau
- Intermodal Area
- New Road Infrastructure and Improvements to Existing Road Infrastructure
- Line of Underground Oil Pipeline and 10m Easement Zone
- Minimum Bund Height (AOD)
- Building Line Limit
- Site Boundary

A	05/03/18	Client name amended			CS
REV	DATE	DETAILS OF ISSUE/REVISION		DRW	REV

ASHFIELD LAND
MANAGEMENT LIMITED AND
GAZELEY GLP
NORTHAMPTON S.A.R.L

THE RAIL CENTRAL RAIL
FREIGHT INTERCHANGE
AND HIGHWAY ORDER
201[X]

DRAWING TITLE

Parameter Plan -
Green Infrastructure Plan
Sheet 3 of 3 at 1:2500

SCALE	1:2500	DRAWN	CS
PAGE SIZE	A1	REVIEWED	BC
REGULATION	5 (2) (o)	DOCUMENT	Parameter Plan

DRAWING STATUS

Planning

DRAWING No	REVISION
1627-15-108	A

Appendix 3: Main SRFI Site Illustrative Masterplan



- LEGEND
- ORDNANCE SURVEY (c) CROWN COPYRIGHT 2017. ALL RIGHTS RESERVED. LICENCE NUMBER 10002432.
COPYRIGHT RESERVED
- BASED ON MK SURVEYS, TOPOGRAPHICAL SURVEY DRAWING.
REF: 2223. DATED JULY 2016. AND ORDNANCE SURVEY INFORMATION.
- ORDER LIMITS
 - ILLUSTRATIVE PROPOSED BUILDINGS
 - PROPOSED PUBLIC RIGHT OF WAY
 - EXISTING LANDSCAPING RETAINED
 - PROPOSED LANDSCAPED OPEN SPACE (INCLUDING SCREENING AND BUNDING)
 - FLOOD ATTENUATION
 - INTERMODAL AREA
 - AREA FOR POTENTIAL P.V. PANELS ON ROOFS
 - INDICATIVE EXISTING CATENARY POSITIONS
 - INDICATIVE PROPOSED CATENARY POSITIONS

B	28-02-18	TITLE UPDATED	PF	MS
A	27-02-18	OS GRID REMOVED	PF	MS
O	06-02-18	FIRST ISSUE	PF	MS
REV	DATE	DETAILS OF ISSUE/REVISION	DRW	REV



THE RAIL CENTRAL RAIL
FREIGHT INTERCHANGE AND
HIGHWAY ORDER 201[x]

DRAWING TITLE
ILLUSTRATIVE COLOUR
MASTERPLAN - SHEET 1 OF 2

SCALE	1:2,500	DRAWN	PF
PAGE SIZE	A0	REVIEWED	MS
REGULATION	DOCUMENT		
5(2)0			
DRAWING STATUS	PLANNING		
DRAWING No	MSA-30708-PL-DCO-112	REVISION	B



MILTON
MALSOR

NORTHAMPTON LOOP

M1 MOTORWAY

UNIT 2

UNIT 1

UNIT 3

UNIT 5

UNIT 6

UNIT 7

POTENTIAL EXPRESS FREIGHT CROSS-DOCK PLATFORM

TRAIN
MAINTENANCE
DEPOT

WEST COAST MAINLINE

BLISWORTH



SHEET 1

SHEET 2

KEY PLAN
1:20,000

LEGEND

ORDNANCE SURVEY (c) CROWN COPYRIGHT 2017. ALL RIGHTS RESERVED. LICENCE NUMBER 100022432.
COPYRIGHT RESERVED
BASED ON MK SURVEYS', TOPOGRAPHICAL SURVEY DRAWING. REF: 2223. DATED JULY 2016. AND ORDNANCE SURVEY INFORMATION.



ORDER LIMITS

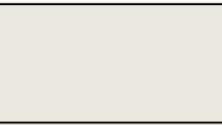

ILLUSTRATIVE PROPOSED BUILDINGS



PROPOSED PUBLIC RIGHT OF WAY

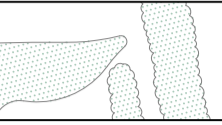

EXISTING LANDSCAPING RETAINED

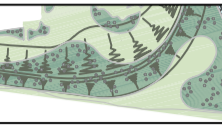

PROPOSED LANDSCAPED OPEN SPACE
(INCLUDING SCREENINGS AND BUNDING)

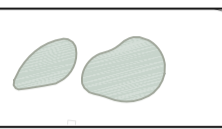

FLOOD ATTENUATION



INTERMODAL AREA

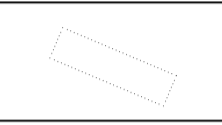

AREA FOR POTENTIAL P.V. PANELS ON ROOFS



INDICATIVE EXISTING CATENARY POSITIONS



INDICATIVE PROPOSED CATENARY POSITIONS

B	28-02-18	TITLE UPDATED	PF	MS
A	27-02-18	OS GRID REMOVED	PF	MS
O	06-02-18	FIRST ISSUE	PF	MS
REV	DATE	DETAILS OF ISSUE/REVISION	DRW	REV



ASHFIELD LAND



THE RAIL CENTRAL RAIL
FREIGHT INTERCHANGE AND
HIGHWAY ORDER 201[x]

DRAWING TITLE
ILLUSTRATIVE COLOUR
MASTERPLAN - SHEET 2 OF 2

SCALE	1:2,500	DRAWN	PF
PAGE SIZE	A0	REVIEWED	MS

REGULATION	DOCUMENT
5(2)0	.





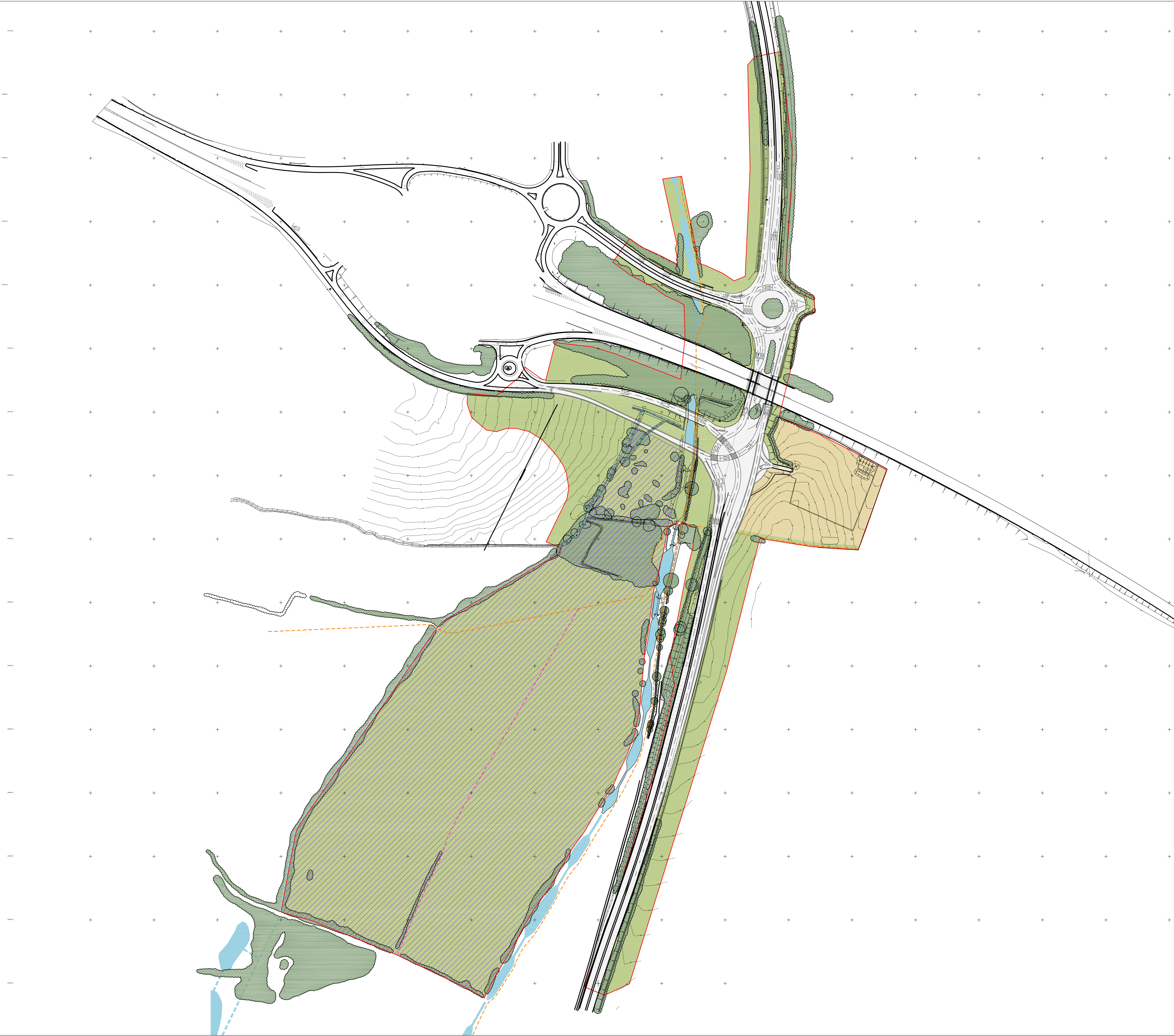
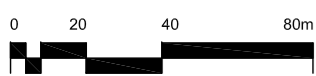
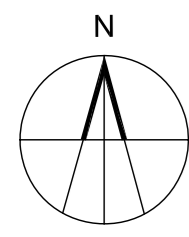

DRAWING STATUS
FEASIBILITY

DRAWING No	REVISION
MSA-30708-PL-DCO-112	B

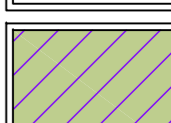
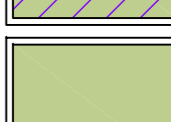
Appendix 4: Junction 15a Site Green Infrastructure Plan

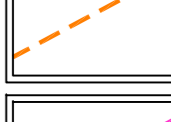
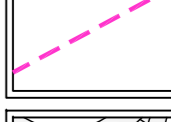

LEGEND

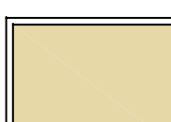
-  Existing Retained Vegetation
-  Primary Green Infrastructure (Ecological Mitigation Zone)
-  Primary Green Infrastructure (Other Soft Landscape Areas)
-  Grand Union Canal
-  Existing Retained Ditchline
-  Existing Retained Public Footpath
-  Proposed Public Footpath
-  Highways Works Including New Road Infrastructure and Improvements to Existing Road Infrastructure
-  Construction Compound (To be reinstated as existing upon completion)
-  Site Boundary

C	05/03/18	Existing road layout removed	CS	-
B	23/02/18	Existing road layout removed	CS	
A	06/02/18	DCO Drawing sheet added	CS	
REV	DATE	DETAILS OF ISSUE/REVISION	DRW	

ASHFIELD LAND
MANAGEMENT LIMITED AND
GAZELEY GLP
NORTHAMPTON S.A.R.L



THE RAIL CENTRAL
RAIL FREIGHT INTERCHANGE
AND HIGHWAY ORDER 201[X]

DRAWING TITLE
JUNCTION 15A
GREEN INFRASTRUCTURE
PLAN

SCALE	1:2000	DRAWN	CS
PAGE SIZE	A0	REVIEWED	BC
REGULATION	DOCUMENT		
5 (2) (I)	GI Plan		

DRAWING STATUS
PLANNING

DRAWING No	REVISION
1627-15-202	C

Appendix 5: Junction 15a Proposals Plan

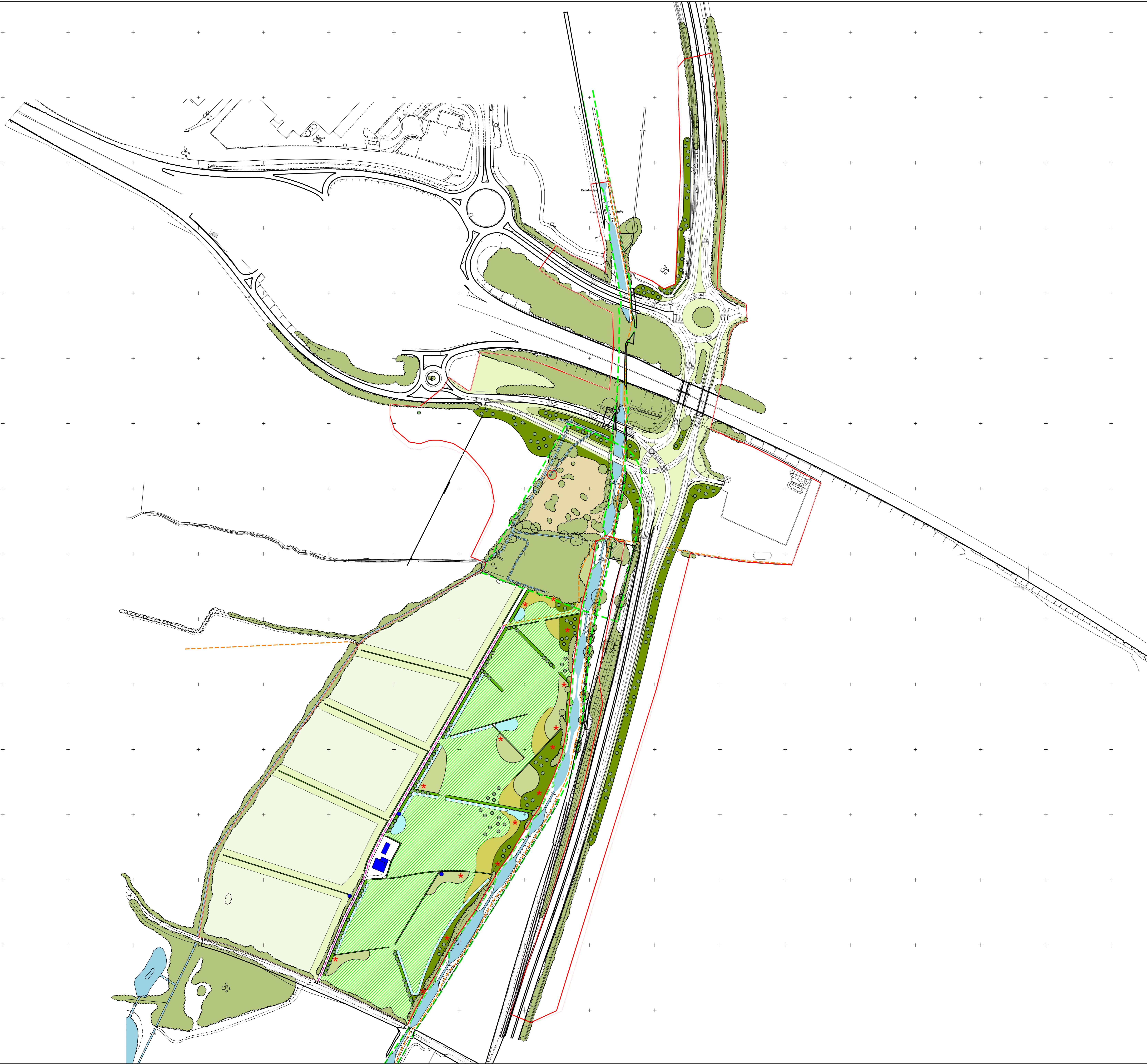

C	05/03/18	Existing road layout removed	CS	-
B	23/02/18	Existing road layout removed	CS	
A	06/02/18	DDO drawing frame added, general amendments	CS	
REV	DATE	DETAILS OF ISSUE/REVISION	DRW	



Rail Central
Northamptonshire

DRAWING TITLE

JUNCTION 15A
ILLUSTRATIVE LANDSCAPE
MASTERPLAN

SCALE	1:2000	DRAWN	CS
PAGE SIZE	A0	REVIEWED	BC
REGULATION		DOCUMENT	
5 (2) (o)		Masterplan	
DRAWING STATUS			
Planning			
DRAWING No			REVISION
1627-15-201			C

Turley Office
40 Queen Square
Bristol
BS1 4QP

T 0117 989 7000