



LEGEND

-  Red Line Boundary
-  Existing 40mph speed limit
-  Existing national speed limit (60mph)

NOTES:

1. The proposed cycleway/footway is to be 3m wide with a minimum 0.5m wide margin along the carriageway edge, unless noted otherwise.
2. Realigned Towcester Road and Northampton Road to have a minimum carriageway width of 6.5m.
3. Existing drainage ditches along the route may be affected in some locations and will need to be considered in more detail.
4. The proposed cycleway/footway is indicative only and is subject to a full topographical survey along the complete route and confirmation of adopted highway/private ownership boundaries.

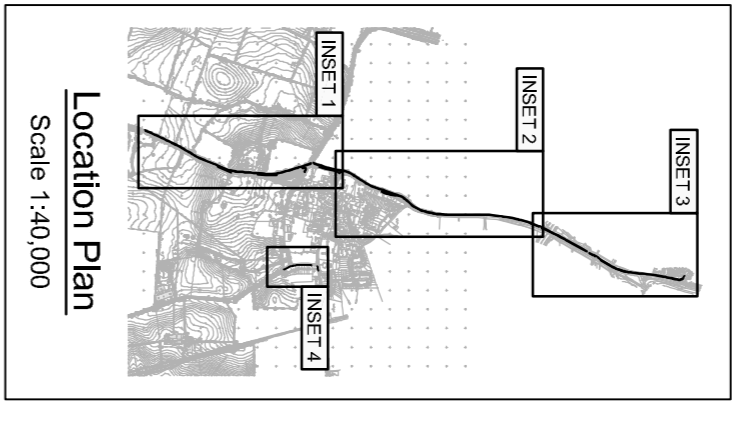

REV	DATE	DETAILS OR ISSUE/REVISION	BY	REV



ASHFIELD LAND



**THE RAIL CENTRAL RAIL
FREIGHT INTERCHANGE
AND HIGHWAY ORDER 201(X)**

DRAWING TITLE
**Highway Plans
General Arrangement
Sheet 7 of 7**

SCALE	1:2,000	DRAWN	PSW
PAGE SIZE	A1	REVIEWED	MB
REGULATION		DOCUMENT	
5(2) (o)			

DRAFT - STAGE 2 CONSULTATION

1211-80/HMP/07

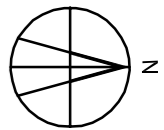

INSET 3 - Milton Park MX To Ladybridge Drive

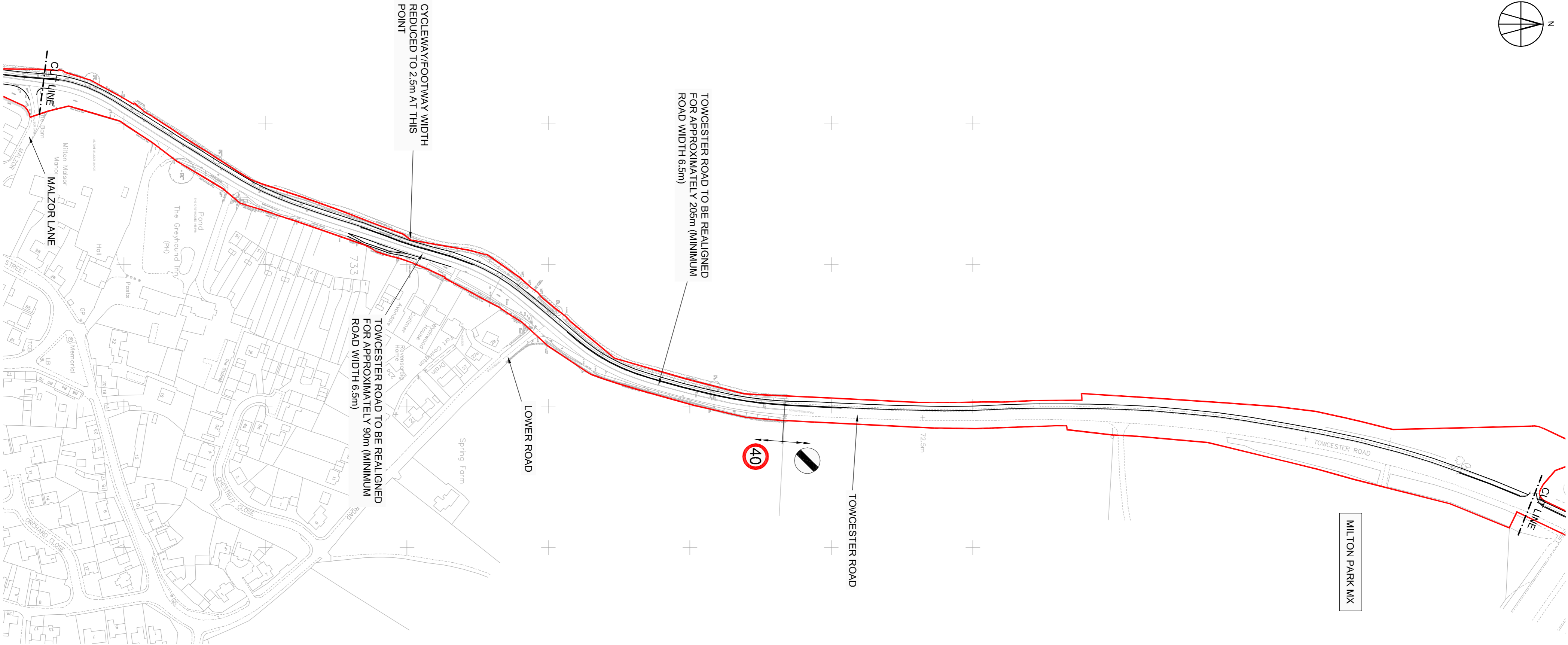
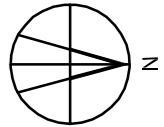

INSET 2 - Malzor Lane To Milton Park MX

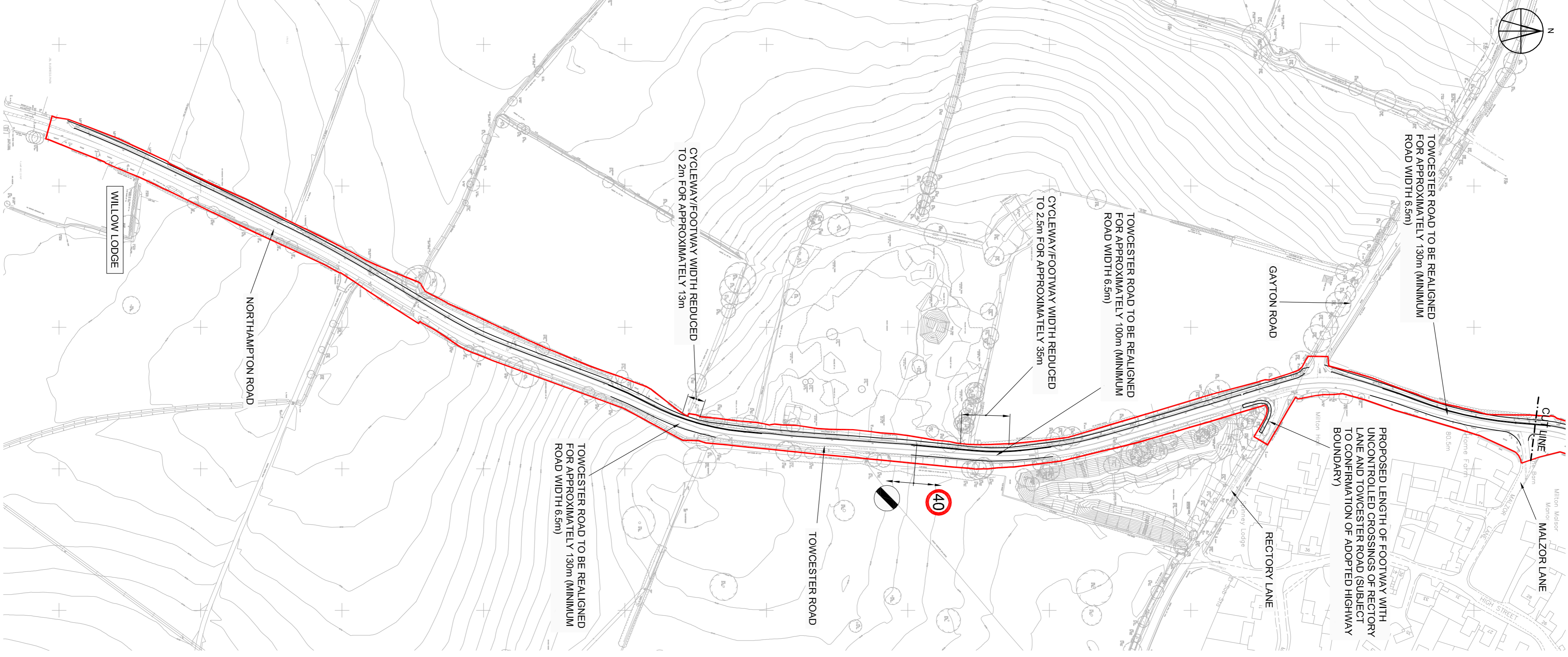
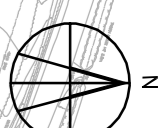

INSET 1 - Willow Lodge To Malzor Lane